

# GRUNDRISS OG3.06

Etage	Etagenflächen	Mietfläche	Pauschalmiete
3. OG	2014 m <sup>2</sup>	27 m <sup>2</sup>	CHF 800

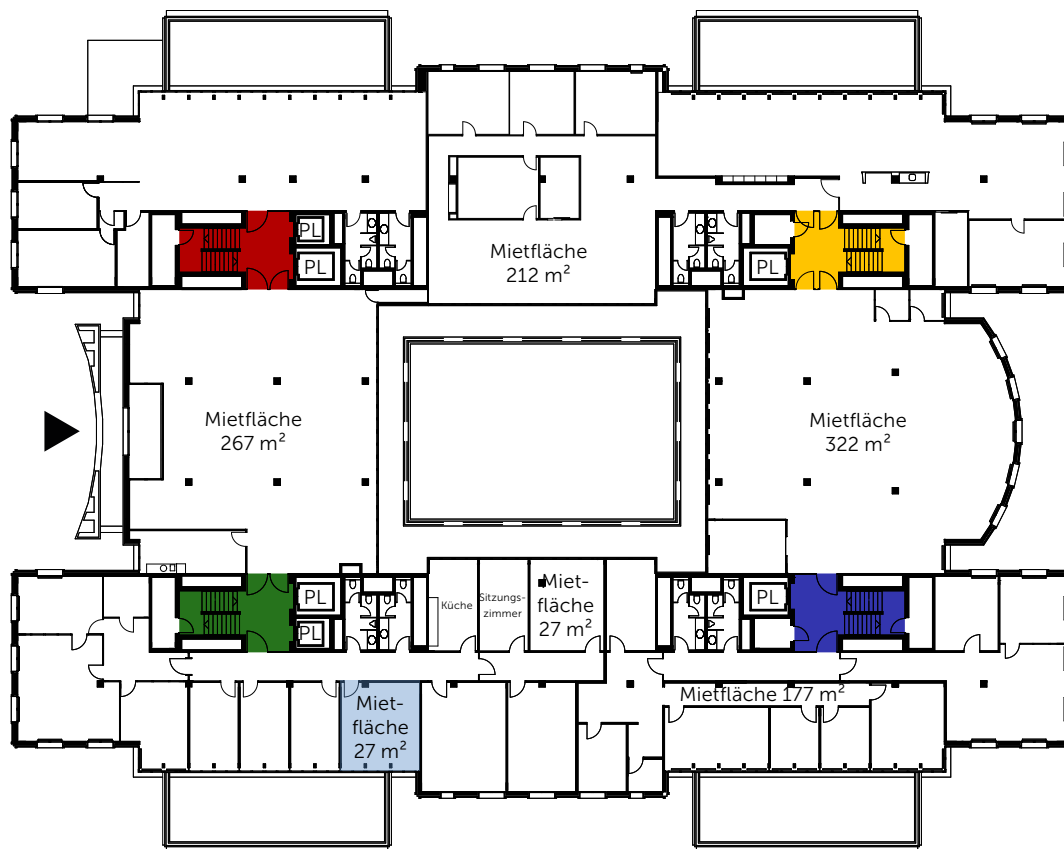

**Liegenschaft**

Lerzenstrasse 10, CH-8953 Dietikon

1:500



**REAL ESTATE AG**



**H&B Real Estate AG**  
Lagerstrasse 107  
8004 Zürich

T +41 44 250 52 52  
plaza@hbre.ch